

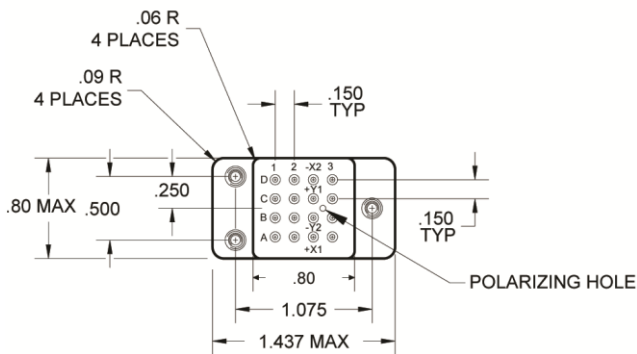

**Basic socket series designation for:**  
Series YL

**Designed to the standards and requirements of:**  
MIL-DTL-12883

### SOCKET DRAWING



### HARDWARE MOUNTING

MOUNTING DETAIL 3 PLACES

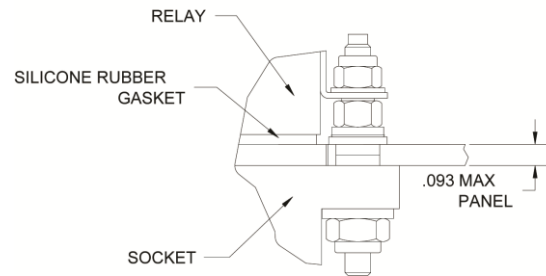

### MOUNTING DIMENSIONS

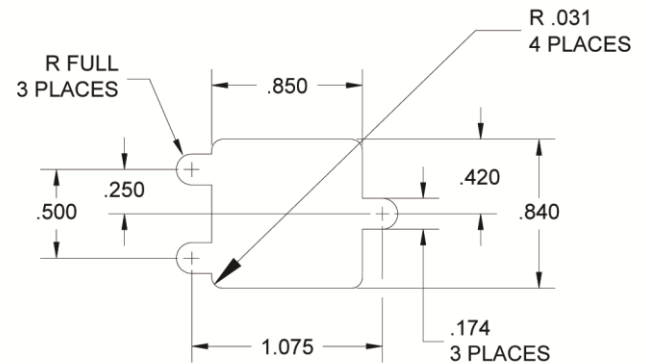
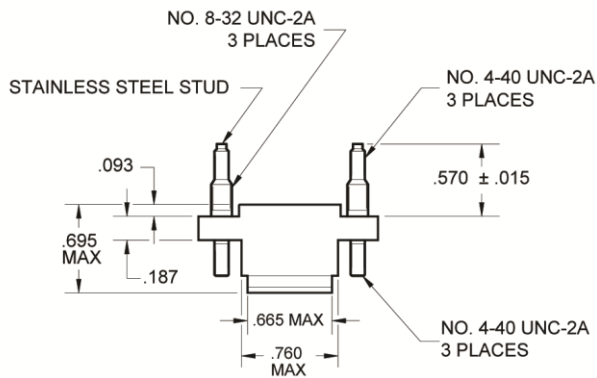

### GENERAL CHARACTERISTICS

<b>1. Supplied with mounting hardware and (16) No. 20 contacts and No. 20 crimp.</b>	
<b>2. Standard tolerances</b>	.xx ± .01; xxx ± .005
<b>3. Weight</b>	.052 lbs. max
<b>4. Special track and module available. Please consult factory, See SM-1002-003.</b>	
<b>5. Operating temperature</b>	-65° C to +125° C